

LME Series

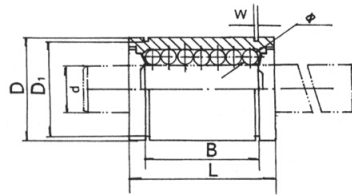

Seal Type	Ball Circuit	Open Type	Ball Circuit	Adjustable type	Ball Circuit	dr (mm)	D(mm)	L(mm)	B(mm)	W(mm)	D1(mm)	h(mm)	h1(mm)	Θ
LME5UU	4	LME5UUOP	-	LME5UUAJ	4	5	12	22	14.5	1.1	11.5	1	-	-
LME8UU	4	LME8UUOP	-	LME8UUAJ	4	8	16	25	16.5	1.1	15.2	1	-	-
LME12UU	4	LME12UUOP	-	LME12UUAJ	4	12	22	32	22	1.3	21	1.5	7.5	78o
LME16UU	5	LME16UUOP	4	LME16UUAJ	5	16	26	36	24.9	1.3	24.9	1.5	10	78o
LME20UU	6	LME20UUOP	4	LME20UUAJ	5	20	32	45	31.5	1.6	30.3	2	10	60o
LME25UU	6	LME25UUOP	5	LME25UUAJ	6	25	40	58	44.1	1.85	37.5	2	12.5	60o
LME30UU	6	LME30UUOP	5	LME30UUAJ	6	30	47	68	52.1	1.85	44.5	2	12.5	50o
LME40UU	6	LME40UUOP	5	LME40UUAJ	6	40	62	80	60.6	2.15	59	3	16.8	50o
LME50UU	6	LME50UUOP	5	LME50UUAJ	6	50	75	100	77.6	2.65	72	3	21	50o
LME60UU	6	LME60UUOP	5	LME60UUAJ	6	60	90	125	102	3.15	86.5	3	27.2	54o